



# Power, Strength & Pride

SKYZONE Parking Systems



PRODUCT CATALOGUE

[erosgroup.net](http://erosgroup.net)

# Skyzone: World-Class Parking Solutions Designed and Manufactured in India - for the World.

## Safety

A safety-first mindset is ingrained in our very being. With rigorous standards and thorough quality checks, we build robust quality products you can depend on for years.

## Excellence

Our pursuit of excellence is what fuels our innovation. Count on us to give you world-class products, precise installation, and lifetime maintenance - all under one roof.

## Commitment

Every promise we make, we keep. We nurture trust through consistency in quality and service, ensuring we earn your loyalty with sheer diligence.

## Integrity

We lead with honesty and hold ourselves to the highest standards. Our relationship with you is founded upon our unwavering commitment to do the right thing.

## Teamwork

Our teams collaborate to study your evolving needs and serve you better with every new project. That's how we exceed your expectations and define success together.

OUR VALUES

EROS GROUP

# Skyzone: World-Class Parking Solutions Designed and Manufactured in India - for the World.

01

## Global Design, Indian Standards:

Engineered to meet Indian codes with world-class manufacturing.

02

## Customized Solutions:

Innovative, flexible designs to meet complex parking needs, accommodating over 500 spaces.

03

## Seamless Execution:

Professional teams ensure flawless project execution with stage-wise audits and dedicated field support.

04

## 24x7 Service Support:

Robust after-sales network backed by a round-the-clock call center.

05

## Advanced Multi-Level Systems:

Solutions featuring traversers, lifters, turntables, and more, designed for maximum efficiency and space optimization

**Skyzone combines cutting-edge technology with customer-centric service to redefine parking excellence.**

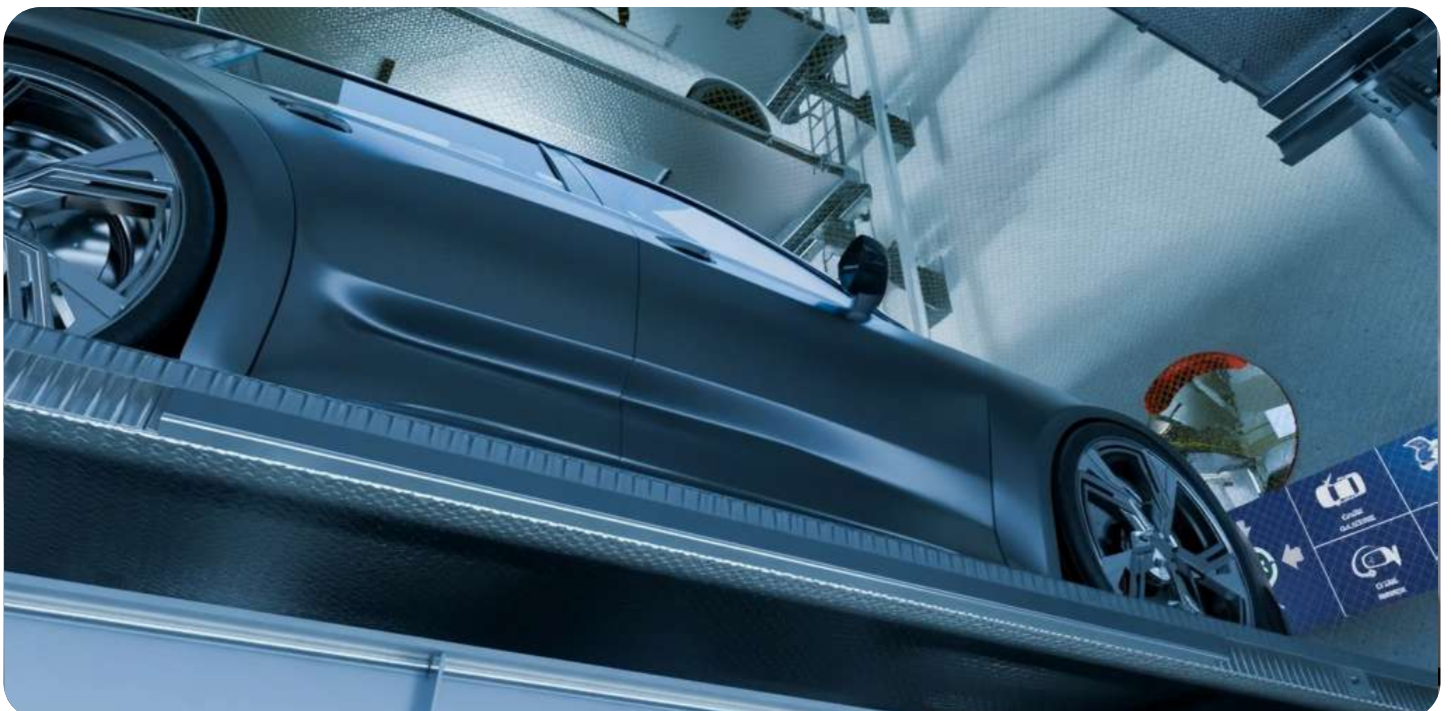

# SERVICE – THE FOUNDATION OF EVERY SKYZONE PARKING SYSTEM

We Promise. We Deliver.

At Skyzone, service isn't an afterthought - it's the heart of everything we do. Before we build parking systems, we build trust. With over 78 years of legacy in vertical mobility, our foundation lies in delivering reliable, responsive, and expert service that keeps every system performing at its best.

As part of the EROS Group, we bring decades of experience maintaining elevators and automated systems across India - experience that translates into unmatched service excellence for your parking infrastructure.

## Why Service Comes First

- Every automated parking system depends on precision, synchronization, and continuous uptime.
- That's why, before we talk about technology, we ensure that your investment is backed by an OEM-trained service team.
- Our engineers understand each component down to its core - because we don't just install these systems, we design and manufacture them.
- Our dedicated service teams ensure every Skyzone parking system operates seamlessly, 24x7.

## The OEM Advantage

- Certified Technicians trained by our R&D and factory experts.
- Smart Tools & Remote Monitoring for instant diagnostics.
- Comprehensive AMC Programs for total lifecycle care.
- Genuine OEM Parts for safety and long-term performance.
- Predictive & Preventive Maintenance to avoid downtime.

## LIFELONG SERVICE PARTNER

Every Skyzone system comes with more than engineering excellence - it comes with a commitment for life.

Our pan-India service network, 24x7 support, and customer-first approach ensure your parking system runs perfectly, every single day.

**With Skyzone, Service Comes Before System. Always.**

# PRODUCT SUMMARY

Skyzone Automated Parking Systems - an EROS GROUP COMPANY offers cutting-edge parking solution designed to optimize urban space and eliminate parking hassles. Engineered for efficiency and safety, Skyzone uses advanced robotics, sensors, and intelligent software to park and retrieve vehicles with minimal human intervention. Whether for residential towers, commercial complexes, or public infrastructure, Skyzone offers space-saving vertical and horizontal configurations, reduced waiting time, and enhanced security - transforming the way cities manage parking.

Skyzone a leading parking solutions provider in India offers tailored automated solutions, including Tower, Cart, HCS & Puzzle types of parking systems, designed to optimize space for low, medium, and high-density projects.



With over 15,000 car spots installed and 5000 under implementation, Skyzone continues to set benchmarks in efficient parking systems.

# Tower Parking System

## KEY FEATURES

- Space Optimization
- Fast and Seamless Operations
- Customizable Configurations
- User-Friendly Access
- Safety First



# TOWER PARKING SYSTEM (STD & SIDE ENTRY)

## Efficient Vertical Parking Solutions

The **SKYZONE** Tower Parking System is an advanced, automated parking solution designed to maximize space efficiency in urban areas. It is a vertical parking structure that utilizes robotics to move and park vehicles in designated slots within the tower.

### Why Choose SKYZONE Tower Parking?

#### Highly Space-Constrained Urban Areas

- Perfect for dense cities with very small land projects.
- Can vertically park 30–70 cars in an area of 3 to 4 cars foot print.

#### High-Cost Real Estate Zones

- In places where land is expensive, like downtowns or commercial zones, vertical expansion saves cost.

#### Locations with High Volume but Limited Area

- Useful for offices, malls, hospitals, railway stations, or public parking where you need:
- High capacity | Small footprint | Fast operation

#### Sites Where Excavation Is Not Feasible

- Built above ground, so no need for deep basements.
- Suitable in flood-prone or rocky soil areas where excavation is not viable.

#### Narrow Plots or Corner Locations

- Suitable for narrow or oddly shaped plots that can't accommodate traditional parking layouts.
- Tower systems can fit in spaces as small as 30–40 sq. meters.

#### Fully Automated Parking Requirements

- No human intervention required – zero manpower needed after setup.
- Tower systems can fit in spaces as small as 30–40 sq. meters.

#### Premium or Valet-Style Parking

- Offers automated, contactless car retrieval.
- Enhances user experience in premium apartments, corporate HQs, and luxury hotels.

#### APPLICATIONS

- High-density urban areas
- Residential complexes
- Commercial buildings
- Mixed-use developments

#### Standard features of TowerParking System

- Fully automatic, humanless system
- Flexible Entry / Exit locations
- Car size and height detecting sensors
- Door open detecting sensors
- Anti-toppling system
- 24x7 service assistance

# TOWER PARKING SYSTEM

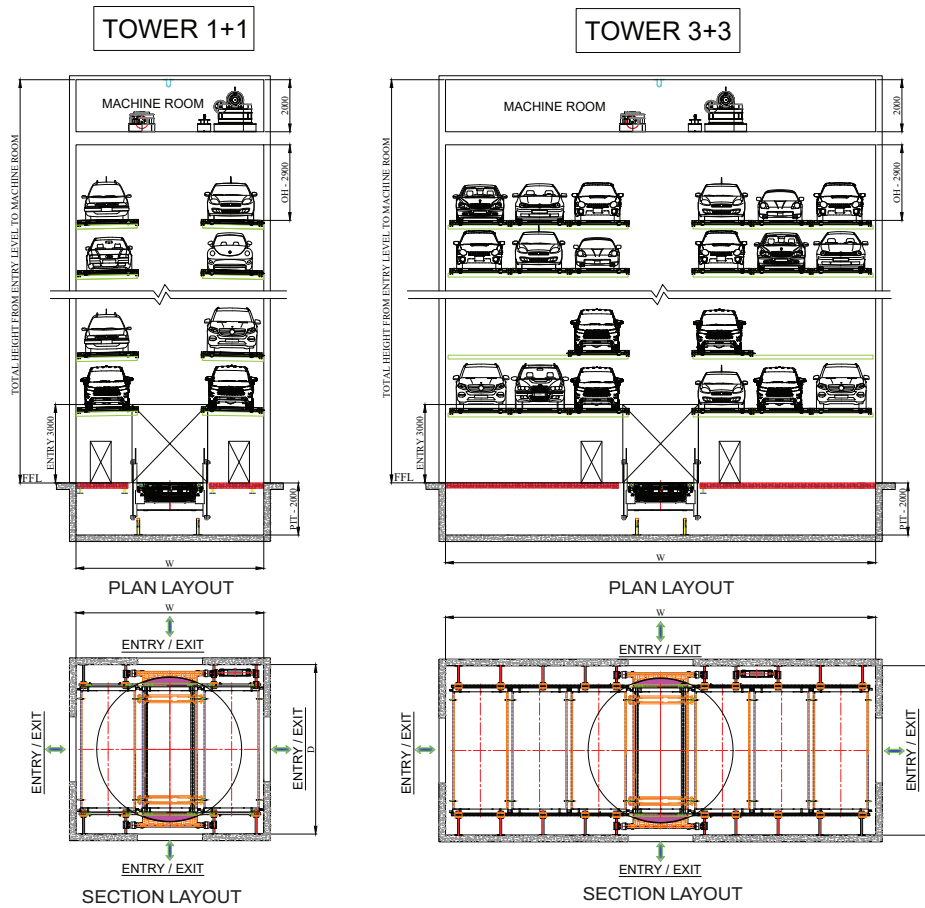

## CAR DIMENSIONS

| PALLET WIDTH | CAR WIDTH OPEN MIRROR (MM) | LENGTH (MM) | WEIGHT (KG)    |
|--------------|----------------------------|-------------|----------------|
| UPTO 2100    | UPTO 2250                  | 5000        | UPTO 2500-3000 |
|              |                            | 5100        |                |
|              |                            | 5200        |                |
|              |                            | 5300        |                |

## CAR DIMENSIONS

| PARAMETERS      | DENOTATION | PALLET WIDTH | TOWER PARKING |      |       |      |      |       |       |       |       |
|-----------------|------------|--------------|---------------|------|-------|------|------|-------|-------|-------|-------|
|                 |            |              | 0+1           | 0+2  | 0+3   | 1+1  | 1+2  | 1+3   | 2+2   | 2+3   | 3+3   |
| ENTRY/EXIT STD  | WIDTH (W)  | 2000         | 5600          | 8000 | 10400 | 7200 | 9600 | 12000 | 12000 | 14400 | 16800 |
|                 |            | 2100         | 5700          | 8100 | 10500 | 7500 | 9850 | 12000 | 12000 | 14600 | 16950 |
| ENTRY/EXIT SIDE | WIDTH (W)  | 2000         | -             | -    | -     | 7300 | 9750 | 12100 | 12100 | 14500 | 16900 |
|                 |            | 2100         | -             | -    | -     | 7600 | 9950 | 12350 | 12350 | 14700 | 17000 |

\*All Dimensions are in mm

# Cart Type Parking System

## KEY FEATURES

- Automated Vehicle Movement
- Space Efficiency
- Customizable Layouts
- Smooth Operation
- Advanced Safety Systems

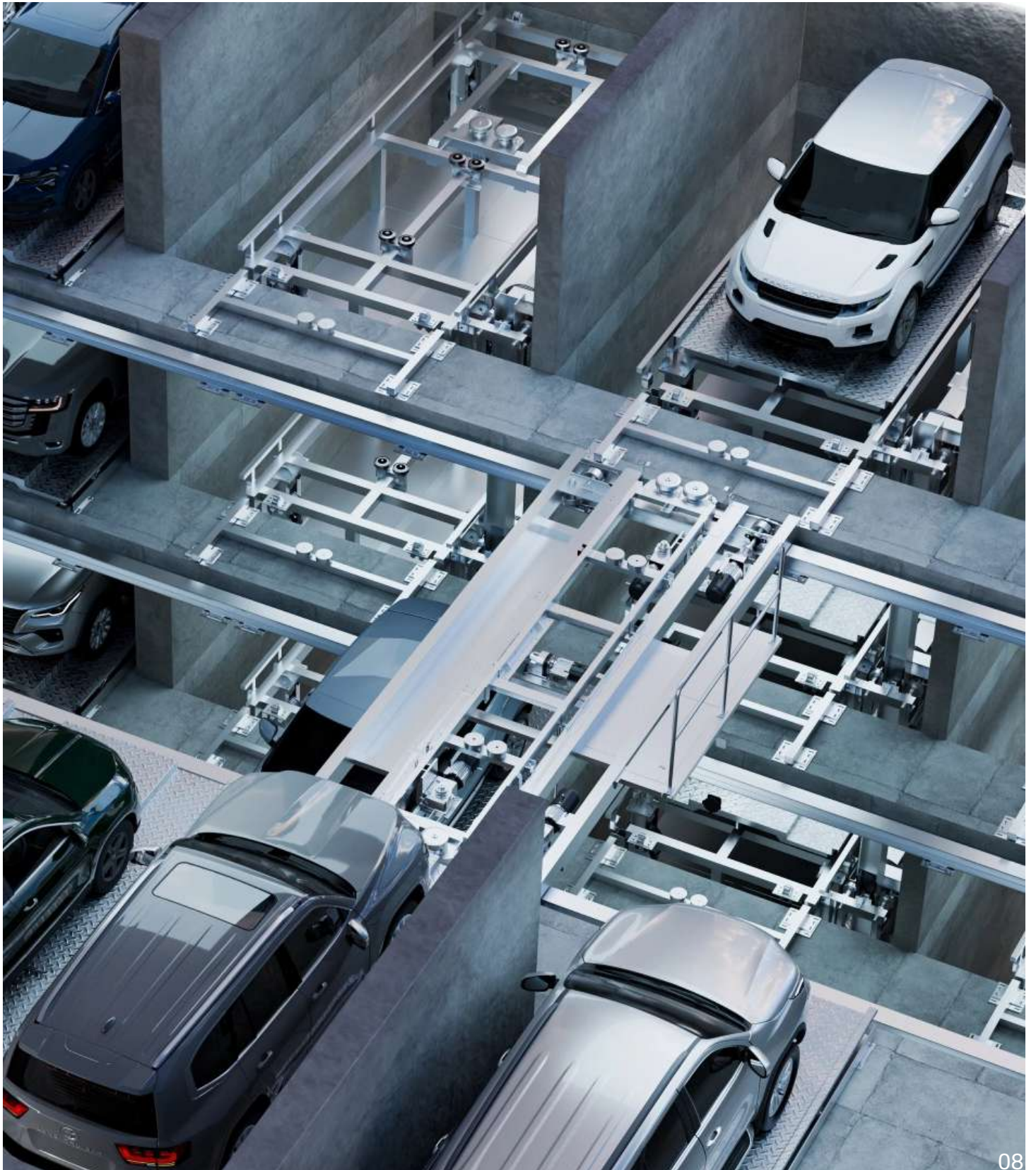

# CART TYPE CAR PARKING SYSTEM

Effortless Parking with Precision

The **SKYZONE** Automated Cart Type Parking System (also known as shuttle) uses motorized carts or shuttles that carry vehicles horizontally and vertically to available parking spaces within a grid. It's a fully automated, high-density parking system ideal for large-scale projects and premium developments.

## Why Choose SKYZONE Cart Type Parking System?

### High-Density Parking Requirements

- Best for large residential complexes, airports, malls, commercial hubs, or IT parks.
- Can handle 100 to 500+ cars efficiently in a compact footprint.

### Premium or Luxury Real Estate Projects

- Ideal for high-end residential towers, smart city projects, or iconic buildings where:
- Aesthetics | User convenience

### Fully Automated Contactless Parking Needed

- Offers touchless experience — no human driver required inside parking zones.

Ideal for:

- Hospitals | Public parking hubs | Corporate campuses

### Fast Retrieval & Simultaneous Operation Required

- Multiple carts and lifts can operate simultaneously, improving retrieval time.
- Useful for rush-hour demand scenarios (e.g., office parks, airports).

### Sites with Irregular or Complex Layouts

- Carts move in both X and Y axes, making them flexible to adapt to non-linear plots or multi-wing buildings.
- Can bypass columns or service ducts during design.

### Projects with High Land Cost or Space Crunch

- Makes the best use of space with multi-level, zero-driveway layouts.
- No need for ramps, drive aisles.

### Green Building or LEED-Compliant Projects

- Reduces vehicle emissions inside parking area due to no engine idling or driving.
- Lower power consumption with intelligent cart pathing and lifts.

### APPLICATIONS

- Residential complexes
- Commercial spaces
- Mixed-use developments
- Hotels and urban centers

# LONGITUDINAL SHUTTLE

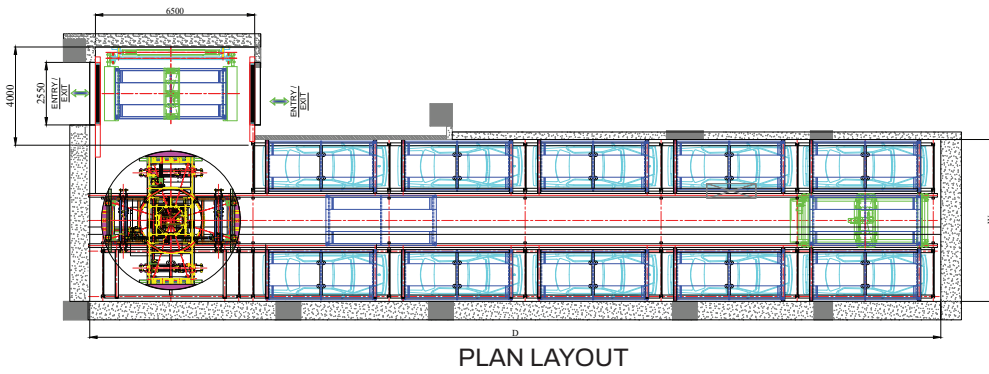

## CAR DIMENSIONS

**PALLET WIDTH** UPTO 2100

**CAR WIDTH OPEN MIRROR (MM)** UPTO 2250

### LENGTH (MM)

|      |      |      |
|------|------|------|
| 5000 | 5200 | 5400 |
| 5100 | 5300 | -    |

**WEIGHT (KG)** 2500-3000

## REQ SHAFT DEPTH

| W(MM) | D(MM) |
|-------|-------|
| 7550  | 35000 |
| 7550  | 34100 |
| 7550  | 34700 |
| 7550  | 35300 |
| 7550  | 35900 |

# SHUTTLE

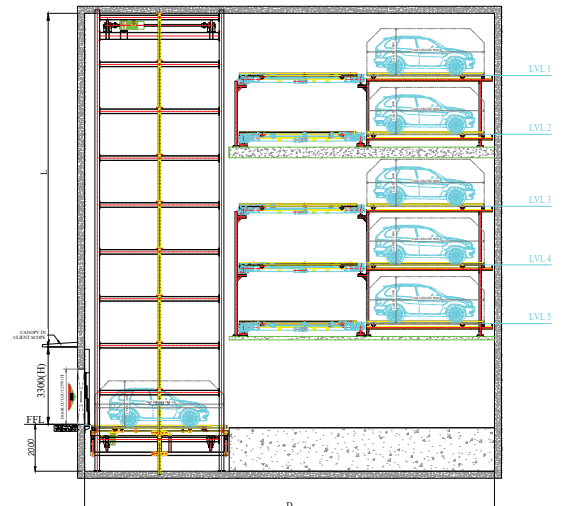
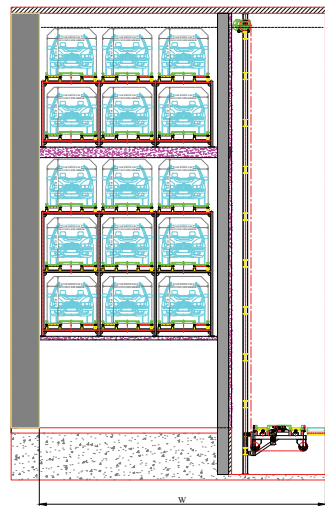
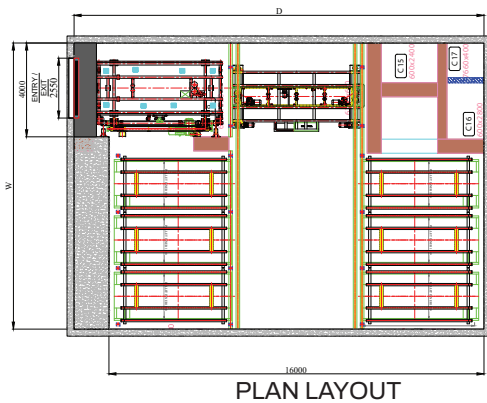

## CAR DIMENSIONS

**PALLET WIDTH**

**CAR WIDTH OPEN MIRROR (MM)**

**WEIGHT (KG)**

UPTO 2100

UPTO 2250

2500-3000

### LENGTH (MM)

|      |      |      |
|------|------|------|
| 5000 | 5200 | 5400 |
| 5100 | 5300 | -    |

## REQ SHAFT DEPTH

| W(MM) | D(MM) |
|-------|-------|
| 12200 | 17500 |
| 12200 | 17500 |
| 12200 | 17500 |
| 12200 | 17500 |
| 12200 | 17500 |

\*All Dimensions are in mm

# HCS Parking System

## KEY FEATURES

- Automated Horizontal Movement
- Space Optimization
- Custom Configurations
- User-Friendly Operation
- Enhanced Safety



# HORIZONTAL CIRCULATION PARKING SYSTEM

Efficient and Space-Saving Parking

The **SKYZONE** Horizontal Circulation Parking System is an innovative automated solution that optimizes parking in circular or linear layouts. Designed for locations with restricted vertical clearance, this system ensures smooth and efficient vehicle storage and retrieval.

## Why Choose SKYZONE Horizontal Circulation Parking System?

### Long and Narrow Foot Prints

- Ideal when the land is rectangular with limited depth but more horizontal width.
- Parking bays can be arranged side-by-side along a horizontal aisle.
- Common in basement parking of commercial or residential buildings.

### Sites with Height Restrictions

- Unlike vertical stacking systems (tower or puzzle-type), horizontal systems require less headroom, making them perfect for:
  - Low-ceiling basements
  - Renovations of older buildings where height can't be increased.

### Retrofitting Existing Structures

- Useful when converting old warehouses or commercial spaces into parking zones.
- The system can be installed without major civil modifications, especially when the structure can't support heavy vertical loads.

Mechanical complexity is lower, making them easier to maintain.

## APPLICATIONS

### Low-Medium Volume Parking Needs

Best for 20–50 nos. car space, not high-density parking requirement.

- Apartment buildings
- Small office complexes
- Hotel Premises

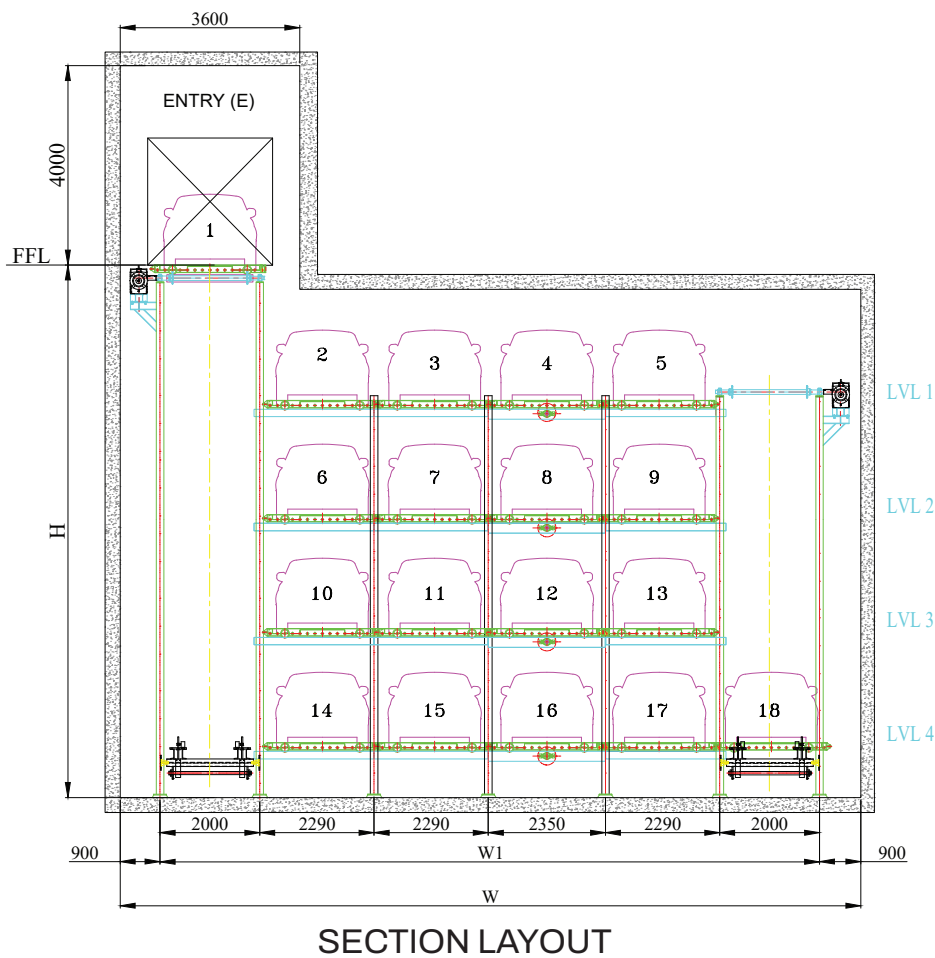
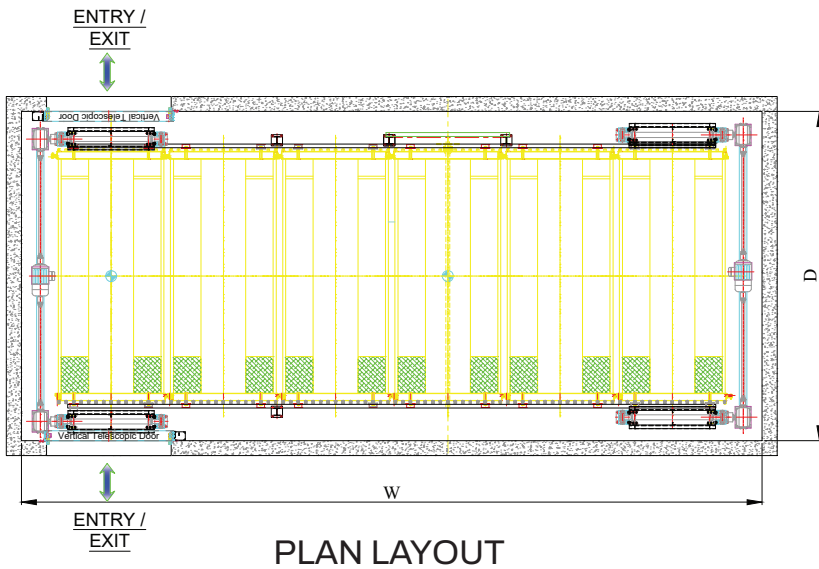

| CAR DIMENSIONS |                                    |             |             |
|----------------|------------------------------------|-------------|-------------|
| PALLET WIDTH   | PALLET WIDTH WITH OPEN MIRROR (MM) | LENGTH (MM) | WEIGHT (KG) |
| UPTO 2100      | UPTO 2250                          | 5000        | 2500-3000   |
|                |                                    | 5100        |             |
|                |                                    | 5200        |             |
|                |                                    | 5300        |             |
|                |                                    | 5400        |             |

| REQ SHAFT DEPTH |        |
|-----------------|--------|
| W (MM)          | D (MM) |
| 15200           | 6400   |
| 15200           | 6500   |
| 15200           | 6600   |
| 15200           | 6700   |
| 15200           | 6800   |

\*All Dimensions are in mm

# OGP-On Ground Puzzle Parking System

## KEY FEATURES

- Modular Design
- Space Optimization
- Customizable Solutions
- Simple and User-Friendly
- Reliable Safety Features



# OGP-ON GROUND PUZZLE PARKING SYSTEM

Intelligent Parking for Maximum Space Utilization

A Puzzle Parking System is an automated parking solution that utilizes a grid-like structure to move vehicles horizontally and vertically within a parking area. It operates like a sliding puzzle, where platforms shift to create a pathway for retrieving or parking vehicles. This system is designed to maximize space efficiency in medium to high-density parking areas.

## Why Choose SKYZONE OGP-On Ground Puzzle Parking System?

### Limited Ground Space but Sufficient Height

- Best for tight urban plots with high land cost. Requires limited footprint but utilizes vertical space.

### Residential & Commercial Buildings

- Apartment complexes | Mixed-use buildings  
Corporate offices
- Offers residents/tenants reserved spots without requiring a full basement.

### Mid-Sized Parking Needs (10–50 Cars)

- Efficient for medium volume parking demand.
- Great balance between automation and cost.
- Often used in hotels, clinics, small malls, etc.

### When Excavation or Basement Construction Is Costly or Not Feasible

- Puzzle systems can be installed above ground or semi-basement.
- Avoids deep excavation — ideal where soil condition or cost prohibits digging.

### Temporary or Modular Parking Needs

- Can be used as a temporary parking solution for under-construction sites or event venues.
- Easy to dismantle and relocate.

### Locations Requiring Individual Access to Cars

- Puzzle systems allow independent car access (unlike some stackers where you need to move another car).
- Ideal for daily-use vehicles in residential or office settings

## APPLICATIONS

- Residential complexes
- Commercial spaces
- Mixed-use developments
- Hotels and urban centers

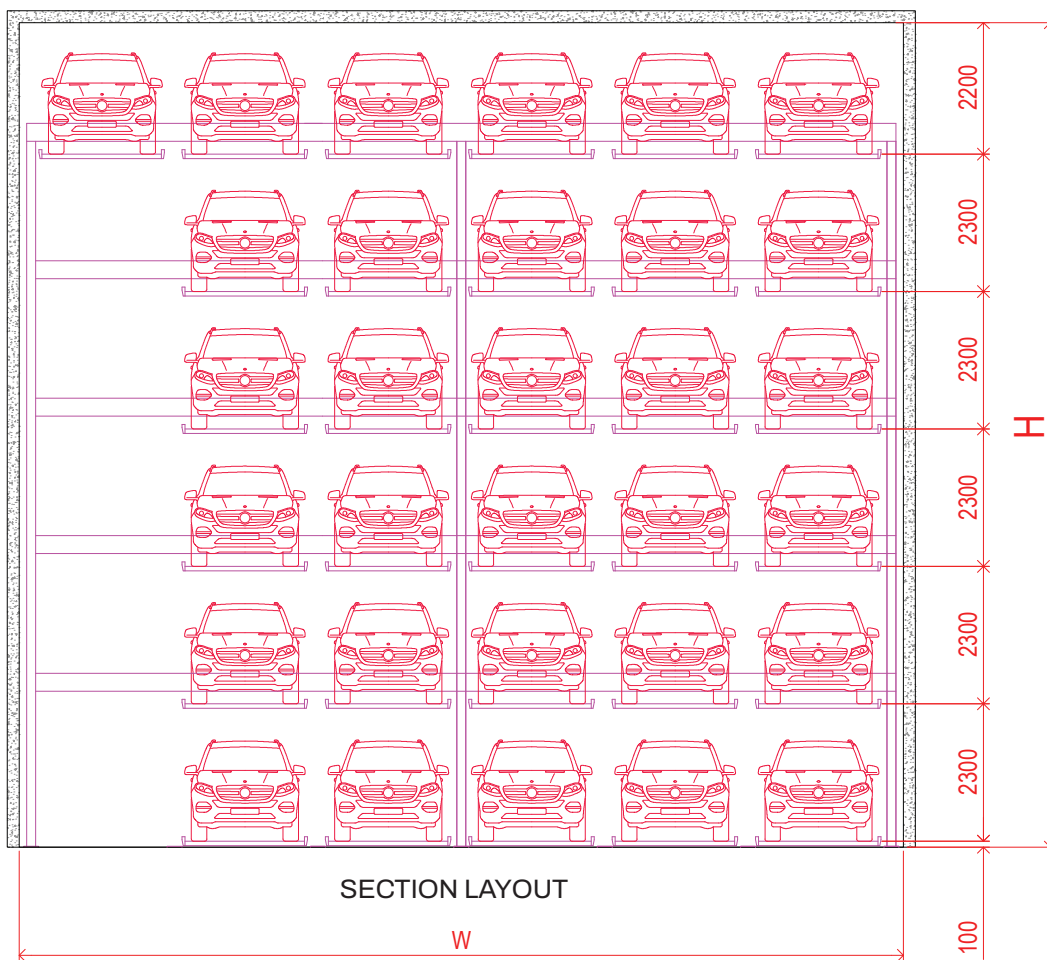
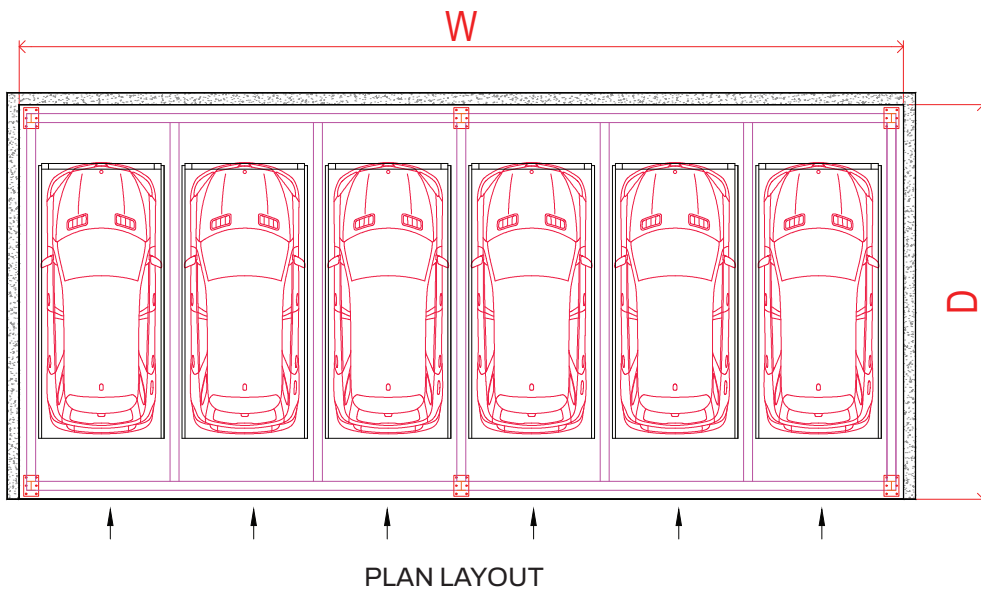

| CAR DIMENSIONS                  |             | REQ. SPACE ON GROUND |
|---------------------------------|-------------|----------------------|
| CAR WIDTH WITH OPEN MIRROR (MM) | LENGTH (MM) | W X D (MM)           |
| 2000                            | 5000        | W X 6300             |
|                                 | 5100        | W X 6400             |
|                                 | 5200        | W X 6500             |
| 2100                            | 5300        | W X 6600             |
|                                 | 5400        | W X 6700             |

\*All Dimensions are in mm

# PARKING SYSTEM PROJECTS



**Rustomjee Summit  
(Borivali)**

Tower Parking 348 Car Parking Spots



**Ruby Hall Clinic  
(Pune)**

Tower Parking 150 Car Parking Spots



**Ashford Palazo**

Tower Parking 96 Car Parking Spots



**Romell Vasanthi**

Tower Parking 104 Car Parking Spots



**Ashar Metro  
(Thane)**

Tower Parking 188 Car Parking Spots



**MGM Hospital  
(Navi Mumbai)**

Tower Parking 100 Car Parking Spots



**SP Designate  
(Khar)**

Atlas Shuttle Parking 55 Car Parking Spots



**Romell Orbis**

Tower Parking 137 Car Parking Spots



**Manglamurti**

Tower Parking 50 Car Parking Spots

# OUR PRESTIGIOUS CUSTOMERS





**EROS GROUP**  
ELEVATORS & PARKING SYSTEMS

The Cutting edge technology  
manufacturer of Automated Parking Systems.

SKYZONE Parking Systems (An Eros Group company)  
Universal Majestic, Unit No.G2, Ground Floor, Off. Eastern  
Express Highway, P. L. Lokhande Marg, Mankhurd Link  
Road, Govandi, Mumbai-400043

**Email: [info@skyzoneparking.com](mailto:info@skyzoneparking.com)**  
**Phone 022 4010 3767**

Follow us



DISCLAIMER:  
Dimensions indicated are subjective and only for reference, actual product and dimensions may vary.  
Specifications are subject to change due to continuous improvement  
We reserve the right to incorporate changes, modify & improvise as per specific application of parking.  
For your special requirements, please do contact:  
SKYZONE Sales representative.